

**ITEM 39. TRAFFIC TREATMENT – CYCLEWAY AND FOOTWAY WIDENING
AND RAISED PEDESTRIAN CROSSING AND IN-ROAD TREES –
LAWSON STREET REDFERN**

TRIM RECORD NO: 2016/123701

RECOMMENDATION

It is recommended that the Committee endorse the following treatments:

- (A) The installation of footway widening on the southern side of Lawson Street, Redfern, east of the intersection of Ivy Lane.
- (B) The installation of five (5) in-lane trees along the southern side of Lawson Street between Little Eveleigh Street and Ivy Lane in lieu of three car spaces.
- (C) The reallocation of kerb space on the southern side of Lawson Street between the points 9 metres and 15 metres west of Little Eveleigh Street as "Loading Zone".
- (D) The installation of footway widening on the southern side of Lawson Street either side of the intersection of Little Eveleigh Street.
- (E) The installation of footway widening on the northern side of Lawson Street across the intersection of Eveleigh Street.
- (F) The installation of a shared path on the northern side of Lawson Street across the intersection of Eveleigh Street with appropriate signs and linemarking.
- (G) The installation of a raised pedestrian crossing in Lawson Street just east of Eveleigh Street.
- (H) The installation of a two-way separated cycleway on the northern side of Lawson Street between Eveleigh and Gibbons Streets.
- (I) Kerb realignment on the north side of Lawson Street/Square at the intersection of Gibbons Street.
- (J) The installation of a two-way separated cycleway on the northern side of Lawson Square between Gibbons and Regent Streets.
- (K) The installation of a shared environment in Lawson Square across the intersection of Regent Place.
- (L) The installation of a shared path on the northern side of Lawson Square on the approach to the intersection of Regent Street and on the eastern side of Regent Street north towards Well Street, with appropriate signs and linemarking.
- (M) A kerb realignment on the southern side of Lawson Square near Regent Street, with a new parking space provided for Australia Post.

VOTING MEMBERS FOR THIS ITEM

<i>Voting Members</i>	<i>Support</i>	<i>Object</i>
City of Sydney		

Roads and Maritime Services		
NSW Police – Redfern LAC		
Representative for the Member for Newtown		

DECISION

BACKGROUND

The Cycling Strategy and Action Plan was adopted by Council in 2007, and subsequently incorporated into the City's long term strategic plan, *Sustainable Sydney 2030*. The City has since planned and largely implemented the delivery of the first suite of infrastructure projects. The Lawson Street and Lawson Square cycleway will complete a missing link for cyclists travelling from Newtown to the eastern side of the CBD.

Lawson Street is also a major pedestrian route between Redfern Station and Sydney University. The improvements to the Lawson Street footway (between Ivy Lane and Redfern Station) will provide methods of improving pedestrian safety on a very narrow footway.

COMMENTS

A bi-directional cycleway is proposed on the northern side of Lawson Street and Lawson Square between Eveleigh and Wells Streets. The cycleway will include an intermittent median separator between the cycleway and the traffic lane to separate cyclists from vehicles, whilst still allowing stormwater to flow through.

The proposal includes a short length of shared path at either end of the new bi-directional cycleway, providing a safe transition into existing cycle provisions in Little Eveleigh Street and Wells Street. Appropriate shared path signs and pavement markings will be deployed to raise user awareness and reduce potential risks.

A cyclist waiting area will be provided in Little Eveleigh Street at the intersection of Lawson Street to allow a space for cyclists to safely wait to cross the road, out of the way of both pedestrians and vehicles.

There will be kerb realignment on the northern side of Lawson Street/Square at the Gibbons Street intersection, to allow for a continuous cycle route through the signalised intersection. This proposal has been approved by the Roads and Maritime Services (RMS).

A raised shared environment is proposed across Regent Place to prioritise pedestrian and cyclist movements and to slow vehicles down.

To improve amenity and safety, the footway will be widened in Lawson Street and Lawson Square at the intersections of Ivy Lane, and Little Eveleigh and Eveleigh Streets.

A new raised pedestrian crossing is proposed with the localised footway widening, to provide priority for pedestrians crossing Lawson Street in front of Redfern Station. This will in turn assist in slowing vehicles down at this intersection.

To meet the RMS warrants for a pedestrian crossing, the proposed location must record pedestrian and traffic flows of equal to or greater than, 30 pedestrians (P) and 500 vehicles (V) per hour for three one-hour periods in a day, and where $P \times V$ is also greater than or equal to 60,000.

The RMS's reduced pedestrian crossing warrant is for volumes greater than 200 vehicles and 30 pedestrians per hour for two one-hour periods on a typical day, and where the proposed crossing is to be used by a high proportion of children or elderly pedestrians.

Pedestrian and vehicle counts have been carried out at this location as follows:-

Time	Vehicles (V)	Pedestrians (P)	$P \times V (>60,000)$	Complies
8:00am - 9:00am	813	721	586 173	Yes
1:00pm-2:00pm	474	119	56 406	Almost
4:00pm-5:00pm	659	246	162 114	Yes
5:00pm-6:00pm	841	395	332 195	Yes

The warrant for a pedestrian zebra crossing was met during all three periods of the day, and a pedestrian crossing is proposed.

The existing trees on the narrow footway along the southern side of Lawson Street between Little Eveleigh Street and Ivy Lane obstruct pedestrian access and therefore will be removed with new trees planted in the road instead. This will improve pedestrian access and safety on the footway (especially for students going to and from the University) while still maintaining local amenity with new trees.

A new loading zone is proposed in Lawson Street near Little Eveleigh Street to service local businesses. The village to village bus-stop will be relocated into Little Eveleigh Street.

As part of a separate project, Lawson Street will soon be a 40km/h zone, making it safer for pedestrians and cyclists.

The design has been developed in close consultation with RMS and Transport for NSW, and with input from other stakeholders in the precinct, such as cycling groups. Through feedback and traffic modelling, the proposal has been refined and received in-principle approval from RMS.

CONSULTATION

Public exhibition of the design plans for the Lawson Street improvements was conducted between 26 October and 11 November 2015.

During this period 580 letters were sent to residents and businesses in the surrounding streets; a webpage was created on sydneyoursay.com.au where submissions could be made; and the concept design was displayed at the One Stop Shop in Town Hall House and Redfern Neighbourhood Service Centre.

The City received 69 submissions, of which 53 submissions were generally supportive of both the footway and cycleway works, with several suggestions being made to improve the designs.

A petition was received, signed by 70 residents from surrounding streets, opposing the Lawson Street footway works. The primary objection is the impact it has on street parking. However, only 3 car spaces will be lost and the benefit to pedestrian safety outweighs the small loss to parking. Additional parking is available nearby in Abercrombie Street which these residents may use.

Consultation was undertaken with the Aboriginal Housing Commission, Redfern Police, Transport for NSW, State Transit Authority, RMS and bicycle groups during the development of the concept design.

FINANCIAL

Funds are available in the current budget.

ATTACHMENTS

Traffic Treatment – Cycleway and Footway Widening and Raised Pedestrian Crossing and In-Road Trees – Lawson Street Redfern

Anton Leddin, Project Manager, Streetscapes

4 Lawson Street footpath improvements

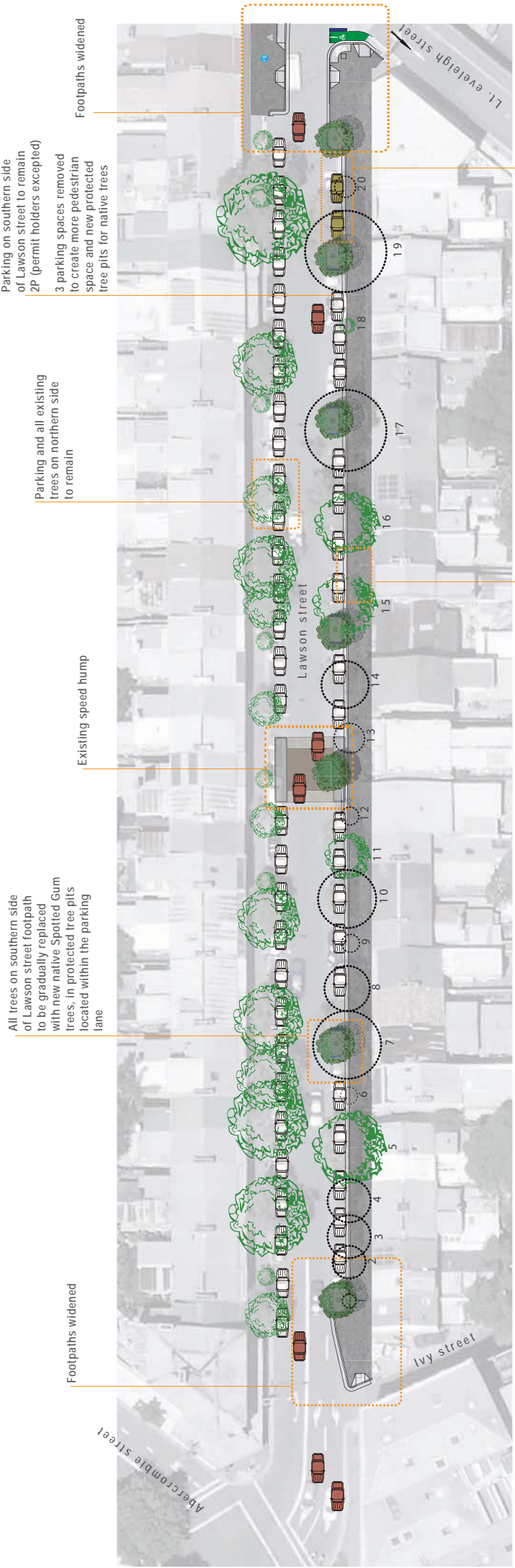

LEGEND

- Parked vehicle
- Moving vehicle
- Loading vehicles
- New tree pits - wheel stops where shown
- New asphalt footpath
- Existing street tree
- Existing street tree to be removed
- New street tree: spotted gum (Corymbia maculata)

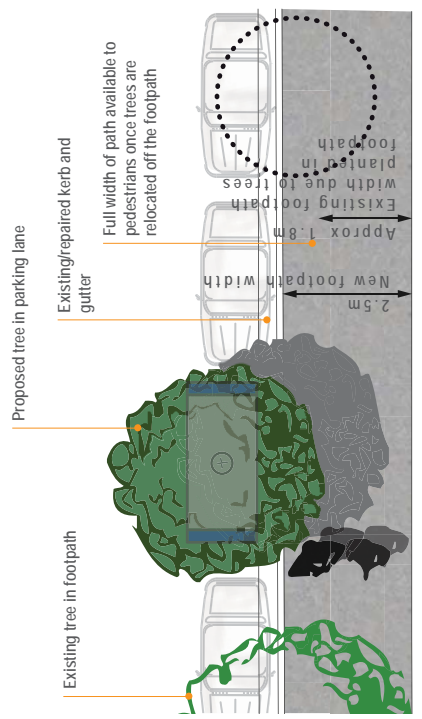

DETAIL PLAN: FOOTPATH WITH NEW TREE PIT, EXISTING TREES RETAINED & REMOVED

5 Lawson Street cycleway

Stop line moved North to enable shared path crossing directly into Wells Street

New separated bi-directional cycleway. Existing bus stop relocated to Redfern street

Shared environment - Refer DETAIL PLAN B

Existing brick paving to be retained and re-used if suitable

Proposed separated bi-directional cycleway

Existing kerb retained. Existing metal fence to be removed

Existing Shared zone at Eveleigh Street

Footpaths widened - Refer DETAIL PLAN A

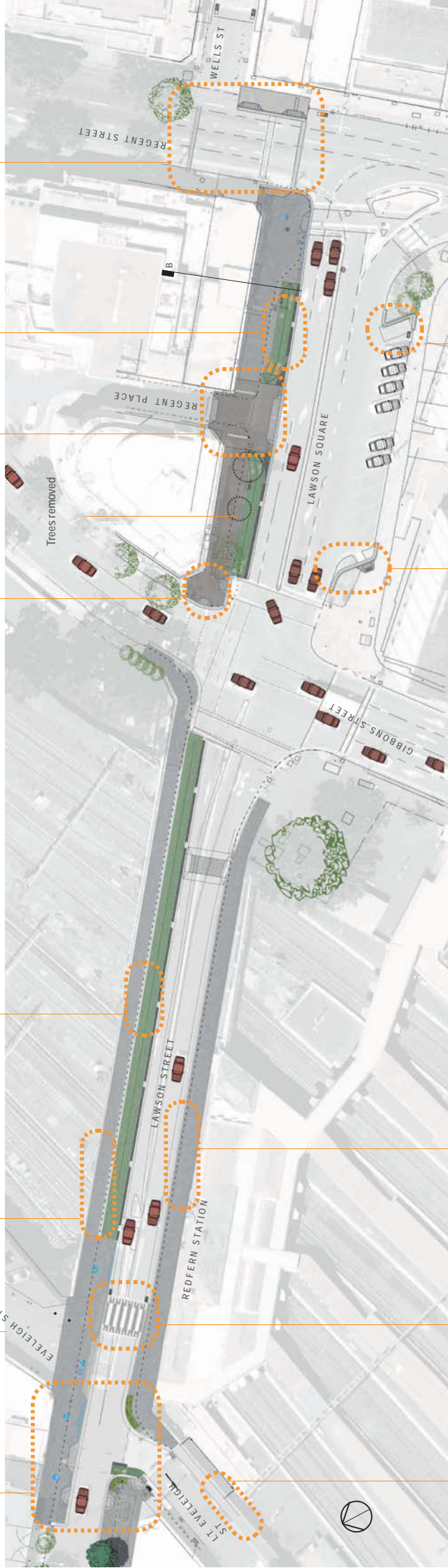

Australia Post mail zone relocated here in new parking space. All other existing parking retained

Adjusted kerb to create new parking space

Footpath widened in front of station. Existing metal fence retained

Proposed raised pedestrian crossing

New Community Bus stop location



DETAIL PLAN B: LAWSON SQUARE CYCLEWAY SHARED ENVIRONMENT INTERSECTION

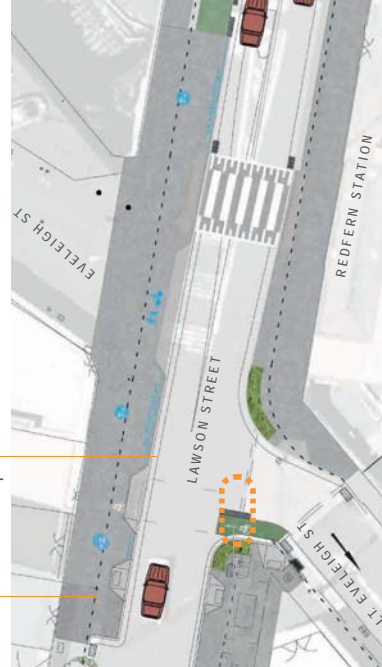

DETAIL PLAN A: LAWSON STREET FOOTPATHS WIDENED

LEGEND

- Parked vehicle
- Moving vehicle
- Loading vehicle
- New tree pit - wheel stops where shown
- New asphalt footpath
- Proposed cycleway
- Existing street tree
- Existing street tree to be removed
- New street tree: spotted gum (Corymbia maculata)
- Brick paving
- Proposed kerb
- Proposed raised pedestrian crossing
- Space for cyclists to wait out of the way of pedestrians and cars

LAWSON STREET AND LAWSON SQUARE FOOTPATH & CYCLEWAY UPGRADE DESIGN DEVELOPMENT

DRAWING SCHEDULE

DRAWING NUMBER	REVISION	DATE	DRAWING DESCRIPTION
2226-DD-101	1	16 March 2016	DRAWING SCHEDULE AND LOCALITY PLAN
2226-DD-102	1	16 March 2016	GENERAL ARRANGEMENT PLAN - SHEET 1 OF 6
2226-DD-103	1	16 March 2016	GENERAL ARRANGEMENT PLAN - SHEET 2 OF 6
2226-DD-104	1	16 March 2016	GENERAL ARRANGEMENT PLAN - SHEET 3 OF 6
2226-DD-105	1	16 March 2016	GENERAL ARRANGEMENT PLAN - SHEET 4 OF 6
2226-DD-106	1	16 March 2016	GENERAL ARRANGEMENT PLAN - SHEET 5 OF 6
2226-DD-107	1	16 March 2016	GENERAL ARRANGEMENT PLAN - SHEET 6 OF 6
2226-DD-108	1	16 March 2016	SECTIONS



LOCALITY PLAN MAP COURTESY OF GOOGLE MAPS
NOT TO SCALE

<p>CITY OF SYDNEY Town Hall House 456 Kent Street Sydney, NSW 2000 www.cityofsydney.nsw.gov.au</p>	<p>10 Regent Street Chippendale NSW 2008 p 02 9262 9800 f 02 9262 9277</p> <p>COMPLETE</p> <p>www.completerurban.com.au</p>	<p>10 Regent Street Chippendale NSW 2008 p 02 9262 9800 f 02 9262 9277</p> <p>COMPLETE</p> <p>www.completerurban.com.au</p>	<p>CITY OF SYDNEY COUNCIL LAWSON STREET & LAWSON SQUARE FOOTPATH & CYCLEWAY UPGRADE DRAWING SCHEDULE AND LOCALITY PLAN</p>
		<p>10 Regent Street Chippendale NSW 2008 p 02 9262 9800 f 02 9262 9277</p> <p>COMPLETE</p> <p>www.completerurban.com.au</p>	<p>CITY OF SYDNEY COUNCIL LAWSON STREET & LAWSON SQUARE FOOTPATH & CYCLEWAY UPGRADE DRAWING SCHEDULE AND LOCALITY PLAN</p>
<p>NOT TO SCALE</p>		<p>NOT TO SCALE</p>	
<p>DESIGN DEVELOPMENT</p>		<p>DESIGN DEVELOPMENT</p>	
<p>Revision - Refer to CDD/06 not issued by hand</p>		<p>Revision - Refer to CDD/06 not issued by hand</p>	
<p>No. 1</p>		<p>No. 1</p>	

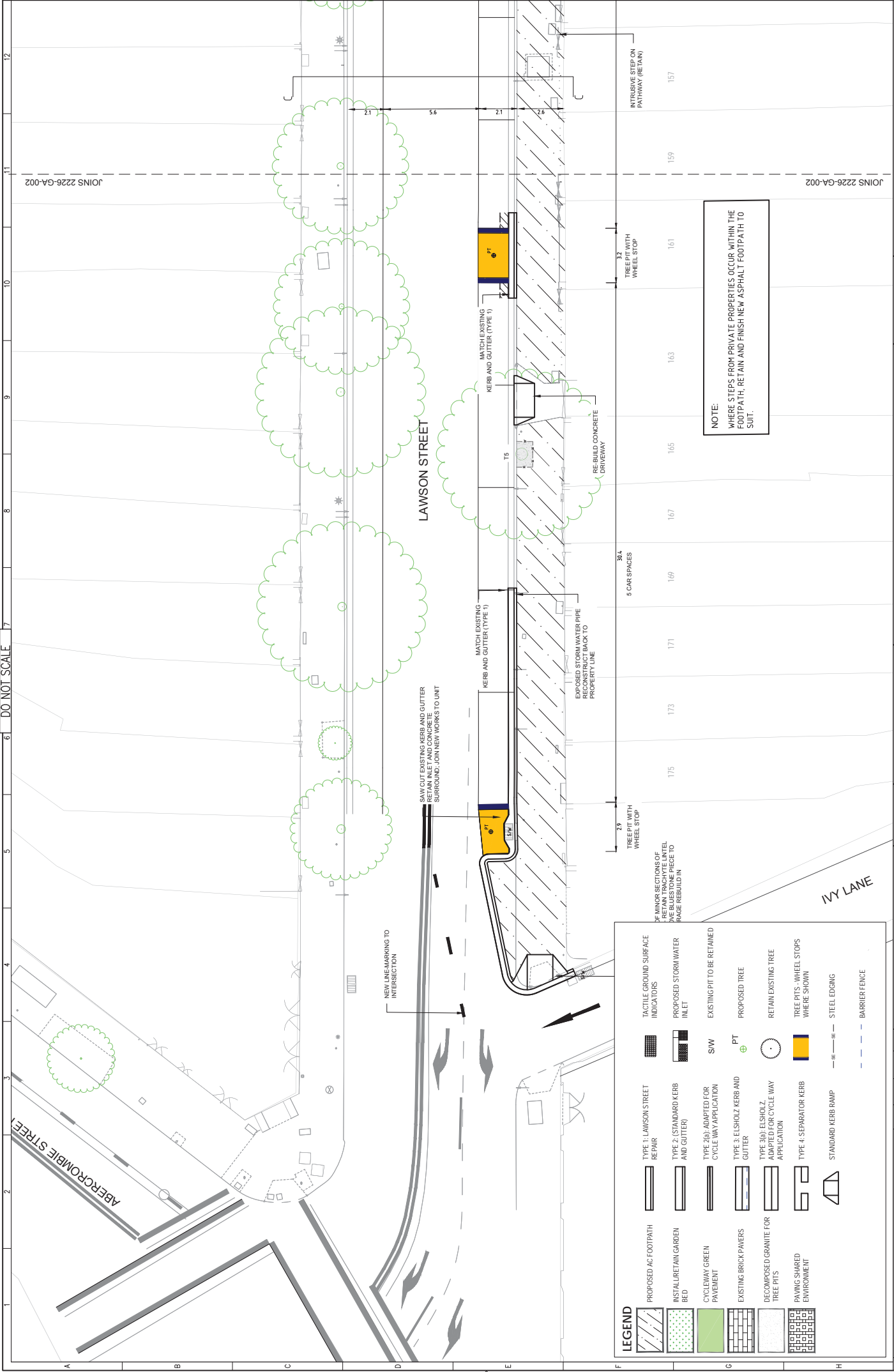

NOTE:
WHERE STEPS FROM PRIVATE PROPERTIES OCCUR WITHIN THE FOOTPATH, RETAIN AND FINISH NEW ASPHALT FOOTPATH TO SOTI.

JOINS 2226-GA-002

JOINS 2226-GA-002

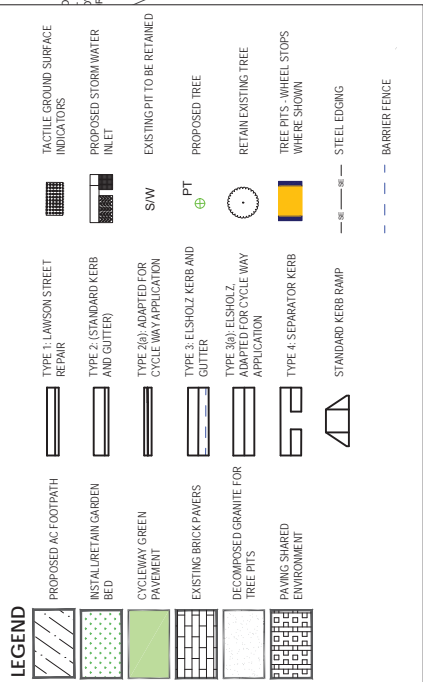

IVY LANE

NEW LINE MARKING TO INTERSECTION

SAW CUT EXISTING KERB AND GUTTER
RETAIN INLET AND CONCRETE
SURROUND - JOIN NEW WORKS TO UNIT

MATCH EXISTING
KERB AND GUTTER (TYPE 1)

MATCH EXISTING
KERB AND GUTTER (TYPE 1)

RE-BUILD CONCRETE
DRIVEWAY

EXPOSED STORM WATER PIPE
RECONSTRUCT BACK TO
PROPERTY LINE

5 CAR SPACES

TREBLE WITH
WHEEL STOP

INTRUSIVE STEP ON
PATHWAY (RETAIN)

10 Regent Street
Chippendale NSW 2008
p 02 9282 9900
f 02 9282 9277

CITY OF SYDNEY
Town Hall House
456 Kent Street
Sydney, NSW 2000
www.cityofsydney.nsw.gov.au

CITY OF SYDNEY COUNCIL
LAWSON STREET & LAWSON SQUARE FOOTPATH & CYCLEWAY UPGRADE
GENERAL ARRANGEMENT PLAN
SHEET 1 OF 6
Dwg: 2226-DD-102

SCALE 1:100	Drawn: AL	Revised: PK
	Checked: PK	Design: PK
	Approved: PK	Noted: PK

NOT FOR CONSTRUCTION
This Drawing must not be used for construction unless signed and stamped as Approved.

Copyright © 2017 City of Sydney
This document is a confidential document. It is the property of the City of Sydney. It is to be used only for the purposes intended and is not to be distributed, copied, reproduced or otherwise used without the express written permission of the City of Sydney. If you are not the intended recipient, you should not disseminate, distribute or copy this document. If you have received this document by mistake, please notify the sender immediately by email at cityofsydney@cityofsydney.nsw.gov.au

1 DESIGN DEVELOPMENT

Revision	Date	By	Appr
1	16/03/16	PK	PK

Revision - Resub on CD. Do not amend by hand.

SCALE 1:50
SCALE 1:100
A1 UNREduced

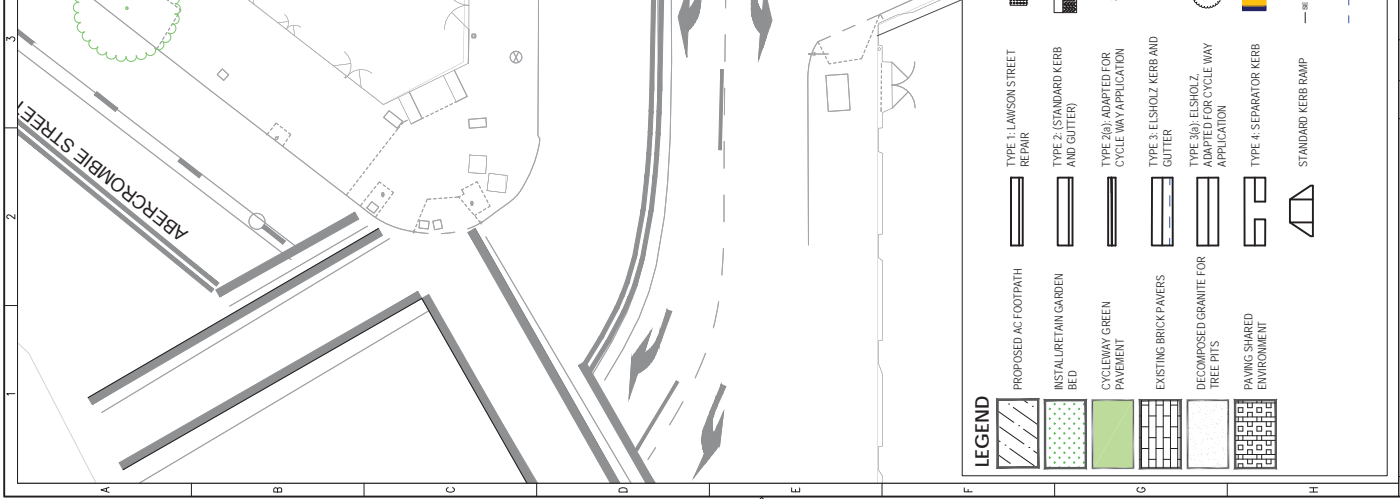
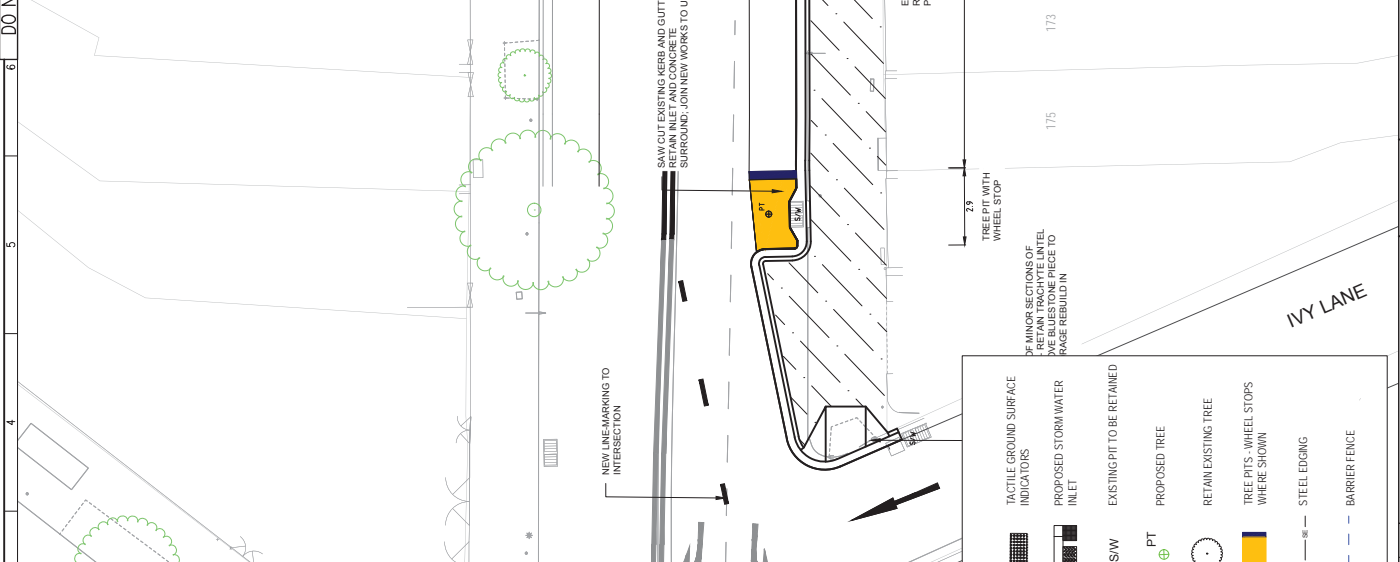
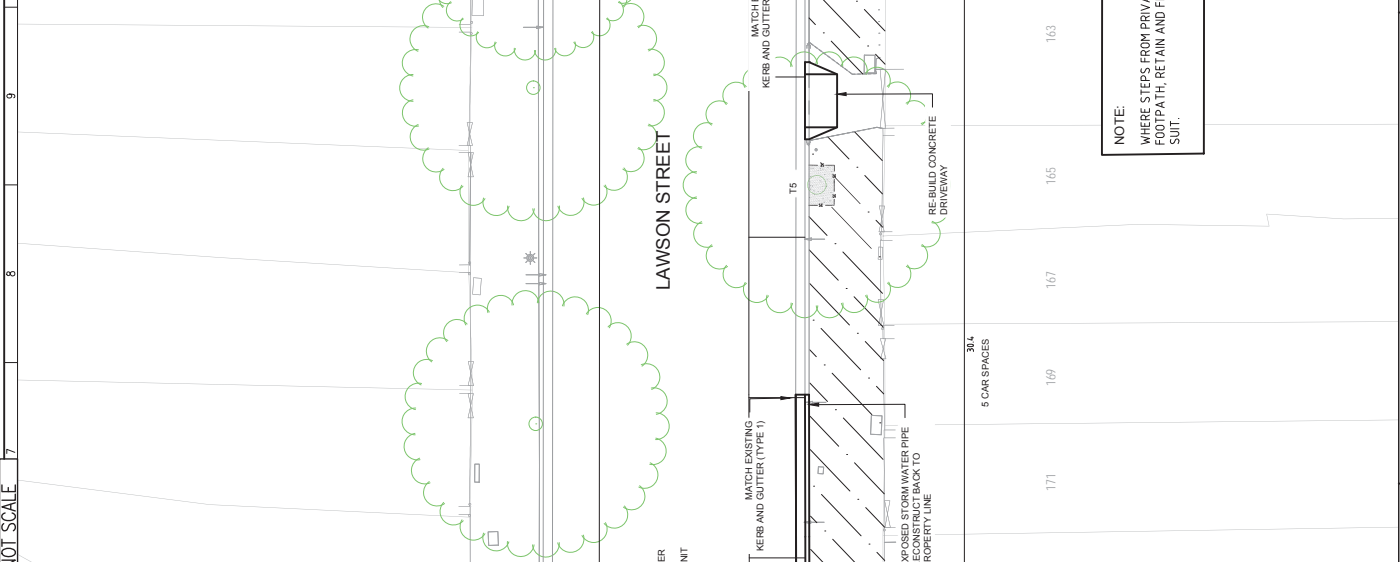
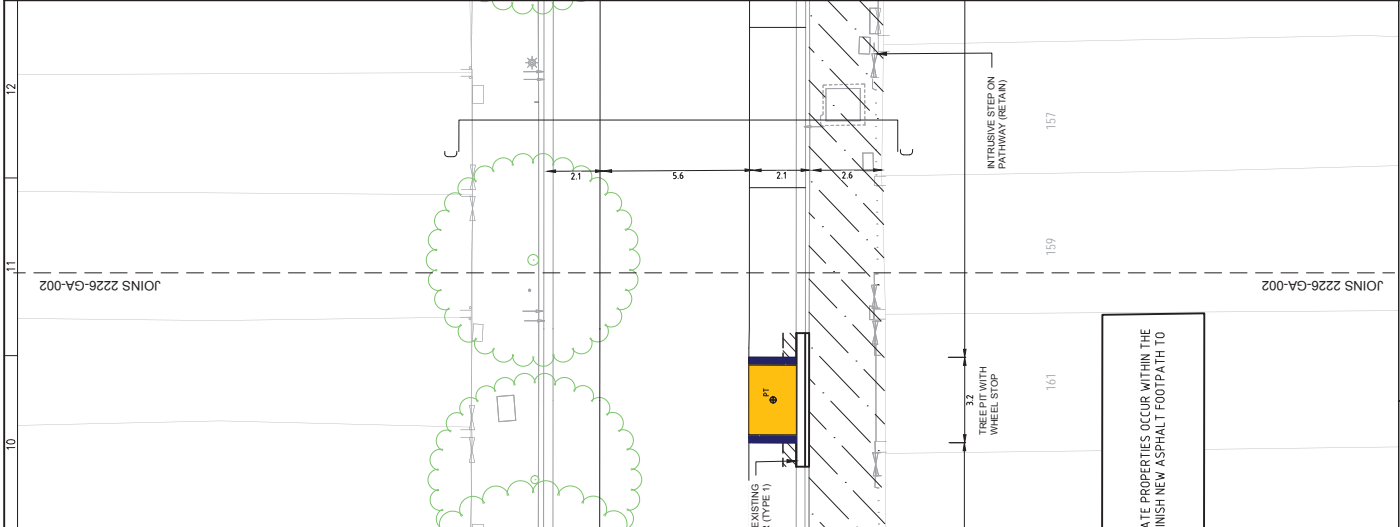

DO NOT SCALE

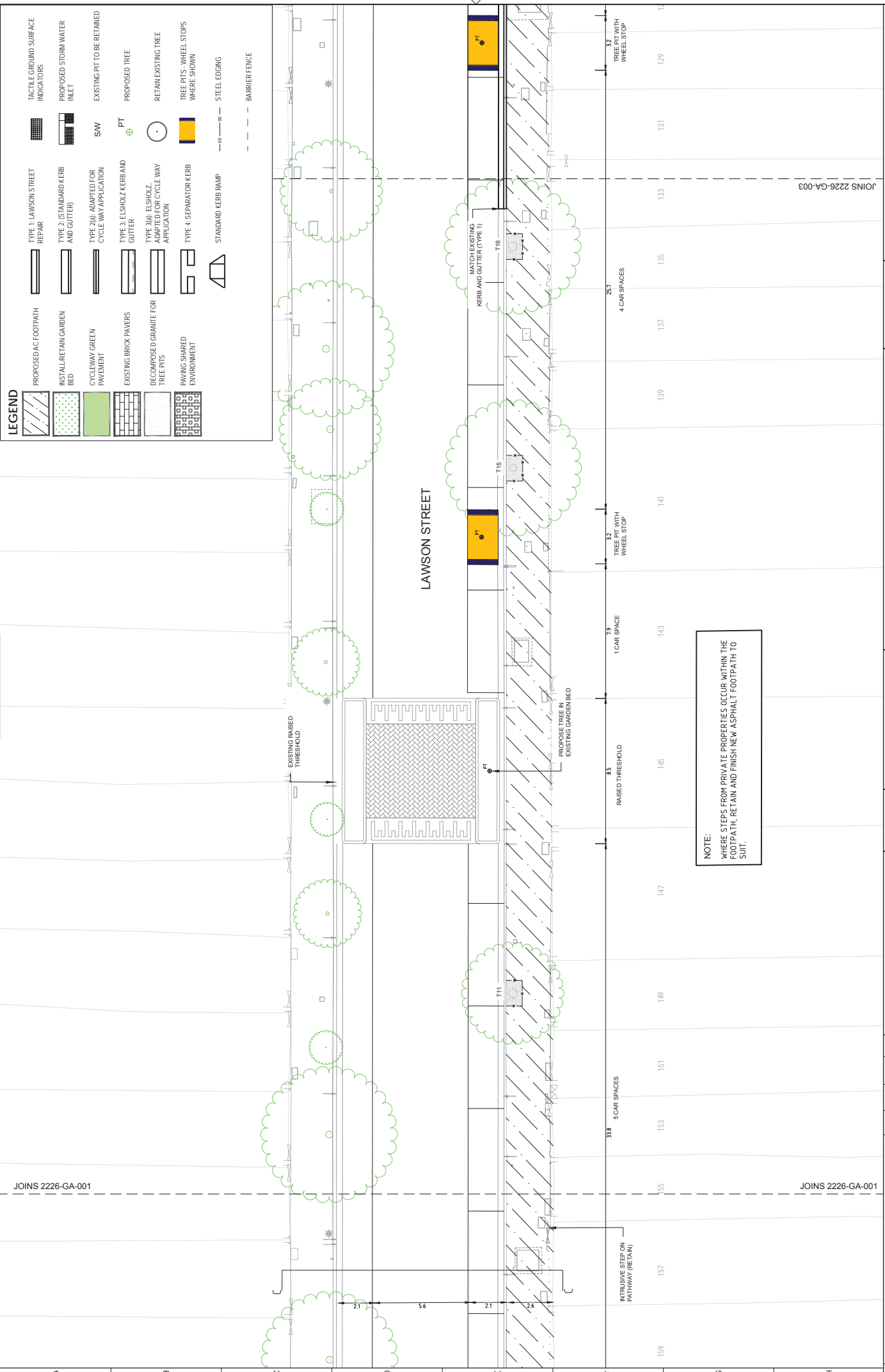

LEGEND

	PROPOSED AC FOOTPATH		TYPE 1 LAWSON STREET REPAIR		TACTILE GROUND SURFACE INDICATORS
	INSTALL RETAIN GARDEN BED		TYPE 2 STANDARD KERB AND GUTTER		PROPOSED STORM WATER INLET
	CYCLEWAY GREEN PAVEMENT		TYPE 3(0) ADAPTED FOR CYCLEWAY APPLICATION		EXISTING PIT TO BE RETAINED
	EXISTING BRICK PAVERS		TYPE 3(1) ELSHOLZ KERB AND GUTTER		PROPOSED TREE
	DECOMPOSED GRANITE FOR TREE PITS		TYPE 3(0) ELSHOLZ ADAPTED FOR CYCLEWAY APPLICATION		RETAIN EXISTING TREE
	PAVING SHARED ENVIRONMENT		TYPE 4 SEPARATOR KERB		TREE PITS - WHEEL STOPS WHERE SHOWN
			STANDARD KERB RAMP		STEEL EDGING
			BARRIER FENCE		

NOTE:
WHERE STEPS FROM PRIVATE PROPERTIES OCCUR WITHIN THE FOOTPATH, RETAIN AND FINISH NEW ASPHALT FOOTPATH TO SUIT.

159	157	155	153	151	149	147	145	143	141	139	137	135	133	131	129
5 CAR SPACES															
RAISED THRESHOLD															
1 CAR SPACE															
TREE PIT WITH WHEEL STOP															
4 CAR SPACES															
TREE PIT WITH WHEEL STOP															
MATCH EXISTING KERB AND GUTTER (TYPE 1)															
EXISTING RAISED THRESHOLD															
PROPOSED GREEN IN EXISTING GARDEN BED															
EXISTING PIT TO BE RETAINED															
PROPOSED TREE															
RETAIN EXISTING TREE															
TREE PITS - WHEEL STOPS WHERE SHOWN															
STEEL EDGING															
BARRIER FENCE															

JOINS 2226-GA-001

JOINS 2226-GA-003

SCALE 1:100

CITY OF SYDNEY COUNCIL
LAWSON STREET & LAWSON SQUARE FOOTPATH & CYCLEWAY UPGRADE
GENERAL ARRANGEMENT PLAN
SHEET 2 OF 6

10 Regent Street
Chippendale NSW 2008
p 02 9282 9800
f 02 9282 9271
www.completdon.com.au

COMPLETE

10 Regent Street
Chippendale NSW 2008
p 02 9282 9800
f 02 9282 9271
www.completdon.com.au

Copyright ©
This document is the property of Complete Don Pty Ltd.
No part of this document may be reproduced, stored in a retrieval system, or transmitted in any form or by any means, electronic, mechanical, photocopying, recording, or by any information storage and retrieval system, without the prior written permission of Complete Don Pty Ltd.

SCALE 1:100
A1 UNREDUCED

DESIGN DEVELOPMENT	Checked	Approved	Date
PJK	PJK		16/03/16

Revision - Refer to CDD for not issued by hand

No. 1

DO NOT SCALE

12
11
10
9
8
7
6
5
4
3
2
1

EVELEIGH STREET

LAWSON STREET

LITTLE EVELEIGH STREET

LEGEND

	PROPOSED AC FOOTPATH		TYPE 1: LAWSON STREET REPAIR		TACTILE GROUND SURFACE INDICATORS
	INSTALL RETAIN GARDEN BED		TYPE 2: STANDARD KERB AND GUTTER		PROPOSED STORM WATER INLET
	CYCLEWAY GREEN PAVEMENT		TYPE 3: ADAPTED FOR CYCLEWAY APPLICATION		EXISTING PIT TO BE RETAINED
	EXISTING BRICK PAVERS		TYPE 4: ELSHOLZ KERB AND GUTTER		PROPOSED TREE
	DECOMPOSED GRANITE FOR TREE PITS		TYPE 300: ELSHOLZ ADAPTED FOR CYCLEWAY APPLICATION		RETAIN EXISTING TREE
	PAVING SHARED ENVIRONMENT		TYPE 4: SEPARATOR KERB		TREE PITS: WHEEL STOPS WHERE SHOWN
			STANDARD KERB RAMP		STEEL EDGING
					BARRIER FENCE

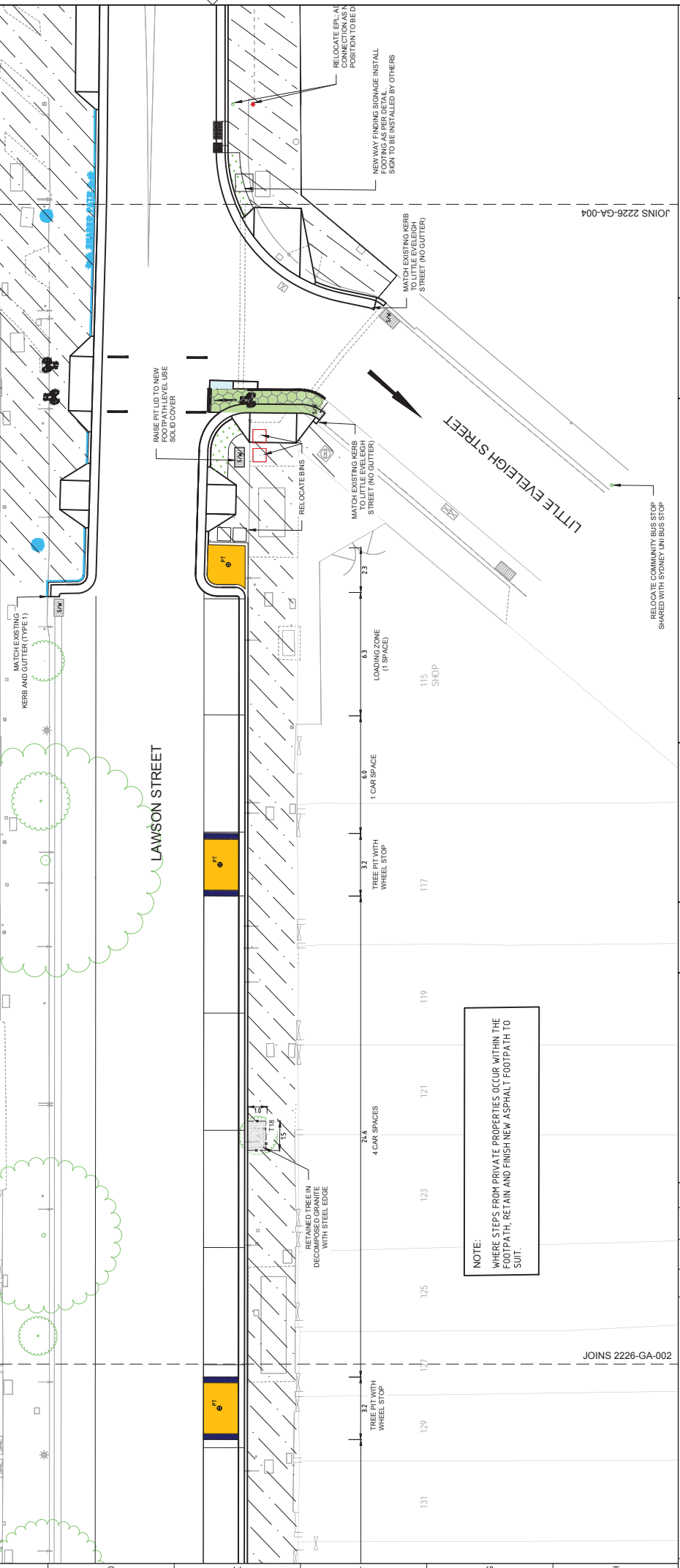

NOTE:
WHERE STEPS FROM PRIVATE PROPERTIES OCCUR WITHIN THE FOOTPATH, RETAIN AND FINISH NEW ASPHALT FOOTPATH TO SUIT.

DESIGN DEVELOPMENT		CHECKED / APPROVED		DATE	
1	DESIGN DEVELOPMENT	P.K.	P.K.	16/03/16	M/20m
Revision - Refer to CAD file not issued by hand		Checked	Approved	Date	Notes

10 Regent Street
Chippendale NSW 2008
p 02 9262 8900
f 02 9265 9333
www.cityofsydney.nsw.gov.au

COMPLETE
10 Regent Street
Chippendale NSW 2008
p 02 9262 9377
f 02 9265 9222
www.completdesign.com.au

10 Regent Street
Chippendale NSW 2008
p 02 9262 8900
f 02 9265 9333
www.cityofsydney.nsw.gov.au

Scale: 1:100

Drawn: A.L. Design: P.K.
 Drafting: P.K. Design Check: P.K.
 Checked: P.K. Approved: P.K.

Scale: A1 UNREDUCED

16/03/16
M/20m

Project: LAWSON STREET & LAWSON SQUARE FOOTPATH & CYCLEWAY UPGRADE
 Title: GENERAL ARRANGEMENT PLAN
 Sheet: 3 OF 6
 Dwg. No.: 2226-DD-104

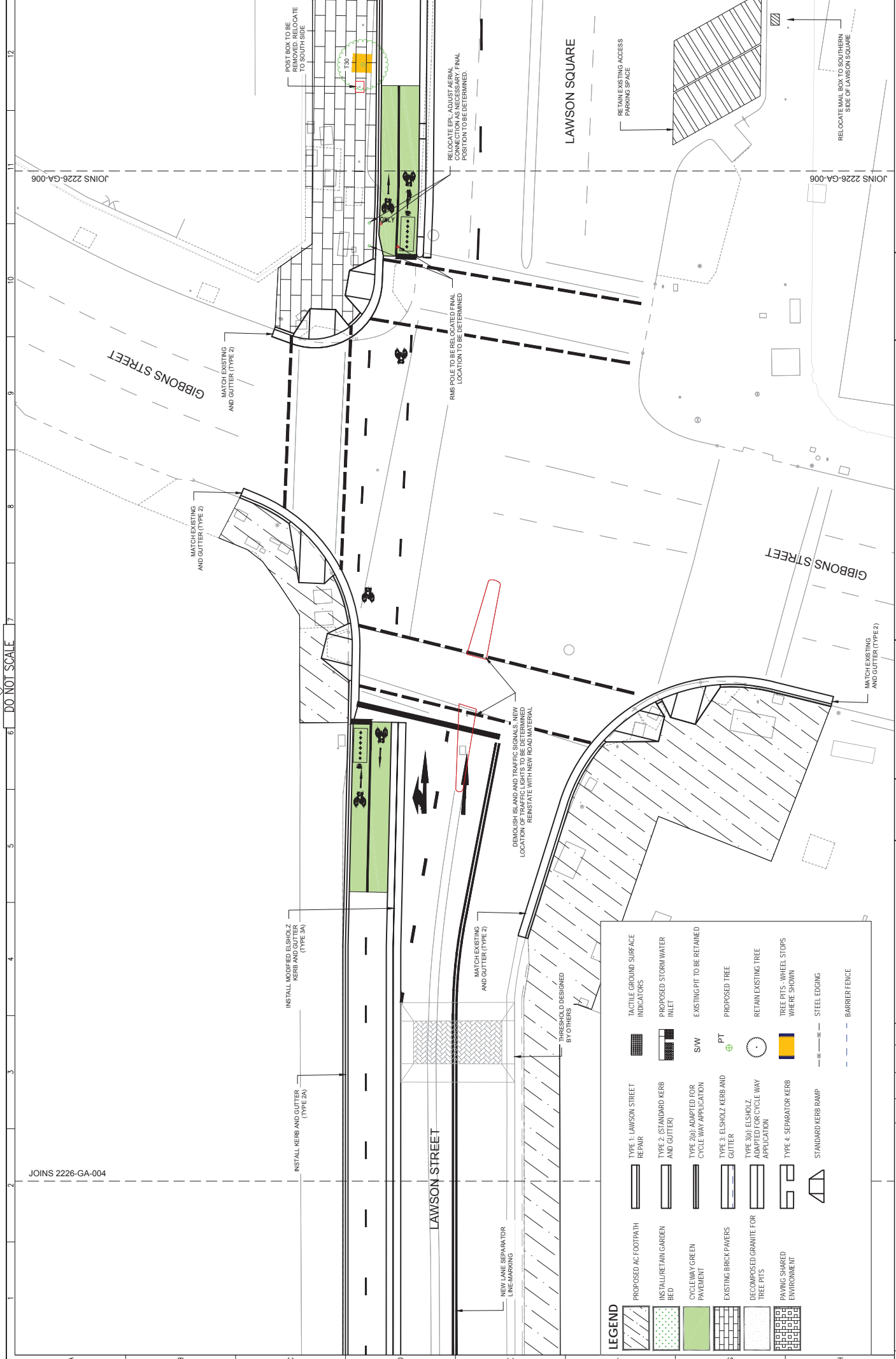

DO NOT SCALE

Grid	1	2	3	4	5	6	7	8	9	10	11	12
A												
B												
C												
D												
E												

LEGEND

	PROPOSED AC FOOTPATH		TYPE 1: LAWSON STREET REPAIR		TACTILE GROUND SURFACE INDICATORS
	INSTALL/RETAIN GARDEN BED		TYPE 2: STANDARD KERB AND GUTTER		PROPOSED STORMWATER INLET
	CYCLEWAY GREEN PAVEMENT		TYPE 2(a): ADAPTED FOR CYCLEWAY APPLICATION		EXISTING PIT TO BE RETAINED
	EXISTING BRICK PAVERS		TYPE 3: ELSHOLZ KERB AND GUTTER		PROPOSED TREE
	DECOMPOSED GRANITE FOR TREE PITs		TYPE 3(a): ELSHOLZ ADAPTED FOR CYCLEWAY APPLICATION		RETAIN EXISTING TREE
	PAVING SHARED ENVIRONMENT		TYPE 4: SEPARATOR KERB		TREE PITs: WHEEL STOPS WHERE SHOWN
			STANDARD KERB RAMP		STEEL EDGING
					BARRIER FENCE

DESIGN DEVELOPMENT	Checked	Approved	Date	DATE
	P.K	P.K	16/03/16	

CITY OF SYDNEY COUNCIL
 LAWSON STREET & LAWSON SQUARE FOOTPATH & CYCLEWAY UPGRADE
GENERAL ARRANGEMENT PLAN
 SHEET 5 OF 6

SCALE	1:100
Drawn	AL
Checked	PK
Designed	PK
Design Check	PK

Scale 1:100
 DRAWN: AL
 CHECKED: PK
 DESIGNED: PK
 DESIGN CHECK: PK

COMPLETE

10 Regent Street | p 02 9262 9800 | **COMPLETE** | City of Sydney
 Chippendale NSW 2008 | f 02 9262 9271 | Chippendale NSW 2008 | p 02 9265 9333 | Town Hall House | 456 Kent Street | Sydney, NSW 2000 | www.cityofsydney.nsw.gov.au

10 Regent Street | p 02 9262 9800 | **COMPLETE** | City of Sydney
 Chippendale NSW 2008 | f 02 9262 9271 | Chippendale NSW 2008 | p 02 9265 9333 | Town Hall House | 456 Kent Street | Sydney, NSW 2000 | www.cityofsydney.nsw.gov.au

DESIGN DEVELOPMENT	Checked	Approved	Date	DATE
	P.K	P.K	16/03/16	

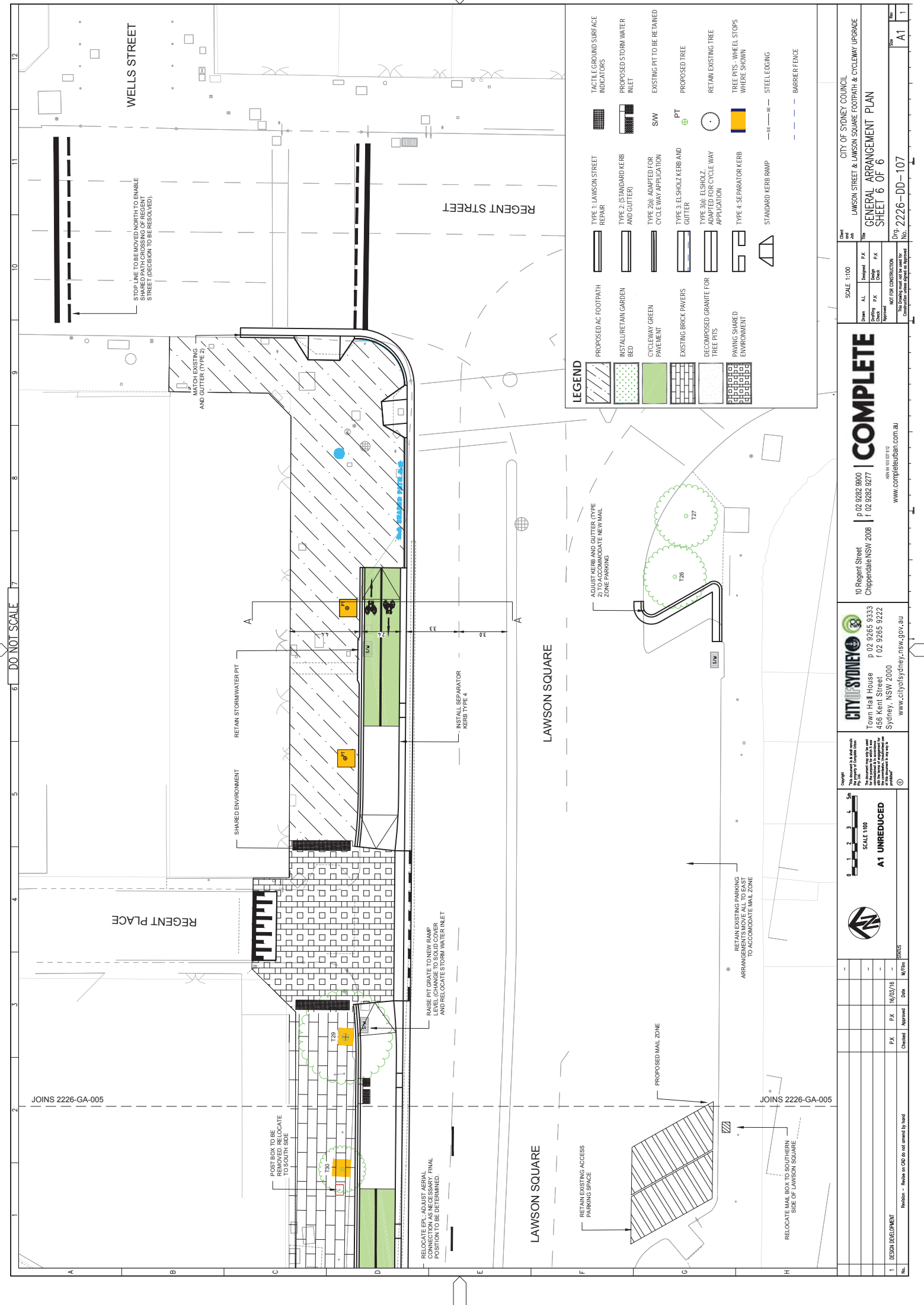

DO NOT SCALE

12
11
10
9
8
7
6
5
4
3
2
1

WELLS STREET

REGENT STREET

LAWSON SQUARE

LAWSON SQUARE

REGENT PLACE

STOP LINE TO BE MOVED NORTH TO EMERALG STREET (DECISION TO BE RESOLVED)

MATCH EXISTING AND GUTTER (TYPE 2)

RETAIN STORMWATER PIT

SHARED ENVIRONMENT

RAISE PIT GRATE TO NEW RAMP LEVEL CHANGE TO SOLID CORNER AND RELOCATE STORM WATER INLET

RELOCATE EPL - ADJUST AERIAL CONNECTION AS NECESSARY. FINAL POSITION TO BE DETERMINED.

ADJUST KERB AND GUTTER (TYPE 2) TO ACCOMMODATE NEW MAIL ZONE PARKING

RETAIN EXISTING PARKING ARRANGEMENTS MOVE TO EAST TO ACCOMMODATE MAIL ZONE

JOINS 2226-GA-005

LEGEND

	PROPOSED AC FOOTPATH		TYPE 1 LAWSON STREET REPAIR		TACTILE GROUND SURFACE INDICATORS
	INSTALL RETAIN GARDEN BED		TYPE 2 (STANDARD KERB AND GUTTER)		PROPOSED STORM WATER INLET
	CYCLEWAY GREEN PAVEMENT		TYPE 2(a) ADAPTED FOR CYCLEWAY APPLICATION		EXISTING PIT TO BE RETAINED
	EXISTING BRICK PAVERS		TYPE 3 (ELSHOLZ KERB AND GUTTER)		PROPOSED TREE
	DECOMPOSED GRANITE FOR TREE PITS		TYPE 3(a) (ELSHOLZ ADAPTED FOR CYCLEWAY APPLICATION)		RETAIN EXISTING TREE
	PAVING SHARED ENVIRONMENT		TYPE 4 (SEPARATOR KERB)		TREE PITS - WHEEL STOPS WHERE SHOWN
	STANDARD KERB RAMP		STEEL LEDGING		BARRIER FENCE

<p>1 DESIGN DEVELOPMENT</p> <p>Scale: 1:100</p> <p>Drawn: AL, Design: PAK, Checked: PAK, Approved: PAK</p> <p>M/F FOR CONSTRUCTION</p> <p>This drawing must not be used for construction without the approval of the author.</p>	<p>Client: CITY OF SYDNEY COUNCIL</p> <p>Project: LAWSON STREET & LAWSON SQUARE FOOTPATH & CYCLEWAY UPGRADE</p> <p>Sheet: GENERAL ARRANGEMENT PLAN SHEET 6 OF 6</p> <p>Proj: 2226-DD-107</p>
	<p>10 Regent Street Chippendale NSW 2008</p> <p>Town Hall House 456 Kent Street Sydney, NSW 2000</p> <p>www.cityofsydney.nsw.gov.au</p> <p>www.completdesign.com.au</p>
<p>SCALE 1:100</p> <p>A1 UNREDUCED</p>	<p>COMPLETE</p>
<p>16/03/16</p> <p>Checked: PAK, Approved: PAK</p>	<p>16/03/16</p> <p>Checked: PAK, Approved: PAK</p>

